



90B Parkmore Road Bentleigh East VIC 3165

 4  3  2

\$1,340

Date available: Now

[Book Inspection](#)

Stylish. Spacious. Brand New. Your Dream Townhouse in Bentleigh East Awaits.

Step into next-level living with this brand new 4-bedroom, 3.5-bathroom designer townhouse, perfectly positioned in the heart of Bentleigh East.

From the moment you arrive, youâ€™ll love the secure electric gate entry, remote single garage, and additional driveway parking. Inside, the wide entrance sets the tone â€“ sleek, spacious, and thoughtfully designed.

Downstairs delivers ultimate flexibility with a private guest suite/4th Bedroom (walk-in robe + luxe ensuite), a separate powder room, and a generous open-plan living and dining zone that flows seamlessly to a fully landscaped backyard. The kitchen is an entertainerâ€™s dream with double ovens, gas cooktop, double sink, dishwasher, and a large walk-in pantry that leads to a practical laundry with outdoor access.

Upstairs is all about comfort and privacy, with a stunning main bedroom suite walk-in robe and ensuite at the front of the home, and two additional bedrooms each with a shared fully tiled bathroom.

Highlights you'll love:

Jellis Craig Bayside and Glen Eira

1 / 9

90B Parkmore Road Bentleigh East VIC 3165

- Four oversized bedrooms, with option of main upstairs and downstairs
- Ducted heating & cooling throughout
- Fully tiled, high-end bathrooms
- Beautifully landscaped, front and rear gardens
- Plenty of storage + quality finishes throughout
- Secure parking behind electric gate and single remote garage

All of this in a fantastic Bentleigh East location, close to local primary and secondary schools, shops including the Mackie Road shopping strip and parklands at Mackie Road Reserve. This exceptional home ticks all the boxes for comfort, convenience, and contemporary style.

Please click [Book Inspection](#) or [Email Agent](#) to register for the inspection. Open for inspections and property availability are subject to change and cancellations, registering your details will ensure you are immediately notified via SMS of any changes or cancellations to inspection times.

Gallery



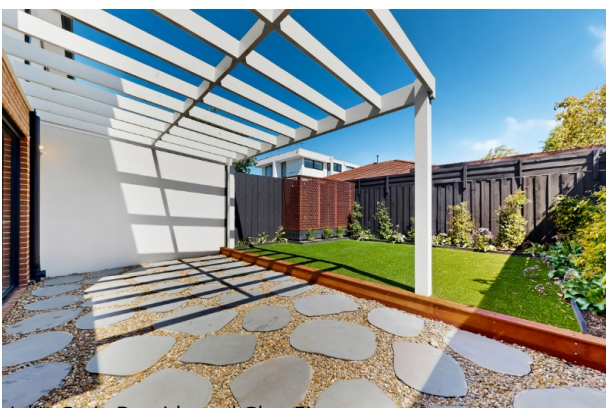



Location Map

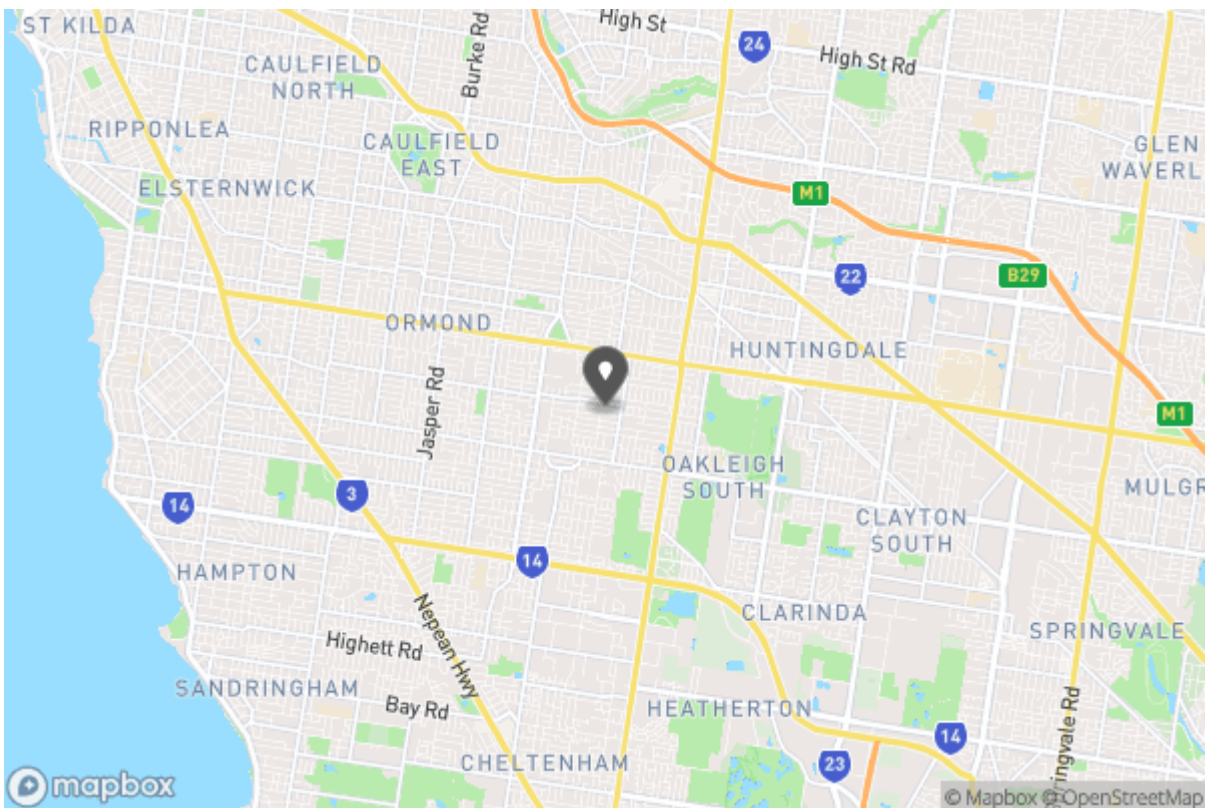

Floor Plans



90B Parkmore Road, Bentleigh East VIC 3165
TOTAL APPROX. FLOOR AREA 205 SQ.M

While every attempt has been made to ensure the accuracy of the floor plan contained here, measurements of doors, windows, rooms and any other items are approximate and no responsibility is taken for any error, omission, or misstatement. This plan is for illustrative purposes only and should be used as such by any prospective purchaser.

JellisCraig



Don't forget to
confirm your
inspection by
SMS or email

Susan Johnston

susanjohnston@jellisrcraig.com.au

9593 4500

Level 1, 277/279 Centre Road
Bentleigh VIC 3204



Why Book with Jellis Craig Bayside and Glen Eira

With our agency, you can book Property Inspections 24/7 on your computer, tablet or smartphone. When you do, you will receive an immediate response confirming your booking via email and SMS. Should the property be leased, the inspection time changed or cancelled for any reason, you will be informed the second it happens keeping you up to date.

You can also change or cancel your booking at any time if you no longer wish to attend or the times are no longer suitable. As part of your booking, we will send you reminders of the inspection as well as directions to the property to make the process of inspecting the property seamless.

Finally, should you wish to apply for the property, all of the relevant information including PDF or online applications details will be provided so you can apply as quickly as possible.

Tenancy Application

A copy of the General Tenancy Agreement for this property, including all special conditions is available via the following link:

[Apply Online](#)

<https://2apply.com.au/Property?agentID=LO-JCBENTLEIGH&uniqueID=1831759>

More Information

For more information about renting through Jellis Craig Bayside and Glen Eira, head to

<http://www.jellisraig.com.au>

To view more properties

[More Properties](#)

<http://www.jellisraig.com.au>