



6/14 Ellendale Road Noble Park VIC 3174

 2  1  2

\$510.00 per week

Date available: Now

[Book Inspection](#)

- ELLENDALE ROAD -

Welcome to 6/14 Ellendale Rd, Noble Park,

Are you looking for a comfortable and well-presented place to call home? This refreshed unit is perfectly suited for renters who value convenience, comfort, and low-maintenance living.

The home has been recently updated with new kitchen & bathroom + modern flooring throughout, fresh paintwork, new light fittings, and electrical upgrades, creating a bright and welcoming space.

Inside, the layout is practical and well-designed, featuring:

- Two spacious bedrooms, each with a full wall of built-in robes
- Newly renovated family bathroom (photo to come)
- Linen press and extra storage cupboard.
- Newly renovated kitchen with new appliances (photo to come)
- Spacious living room, filled with natural light
- Gas wall-furnace
- Ample guest parking (up to 5 spots)
- Small complex, located down the end of a long driveway

Elite Property Management Group

1 / 8

6/14 Ellendale Road Noble Park VIC 3174

A private courtyard flows through from the home & a single lock up garage adds convenience and security. This home offers everything you need for comfortable living, in a location that's™ easy to enjoy.

TO INSPECT THIS PROPERTY

To attend this inspection, you must pre-register. By clicking the "Book Inspection" button you will be notified of all available inspection dates and times plus any changes that may occur.

TO APPLY FOR THIS PROPERTY

We welcome applications to be submitted pending inspection.

To submit your application on this property please use 2Apply. Visit our website at www.elitepmg.com.au select the property address and select Apply Online.

COMPLIANCE CHECKS

This property has or is in the process of undergoing all compliance testing. A copy of the safety reports will be available to the successful renter.

DISCLAIMER

Elite Property Management Group has relied in good faith in the preparation of information provided. Elite Property Management Group has made all reasonable efforts to ensure all information provided to you is true & correct. The accuracy of the information provided to you cannot be guaranteed. If you are considering this rental home, you must make all enquiries necessary to satisfy yourself that all information is accurate.

Gallery





-HOW TO APPLY-

To apply for this property & submit your application please use 2Apply.

Visit our website at www.elitepmg.com.au
select the property address and select Apply Online.



Location Map

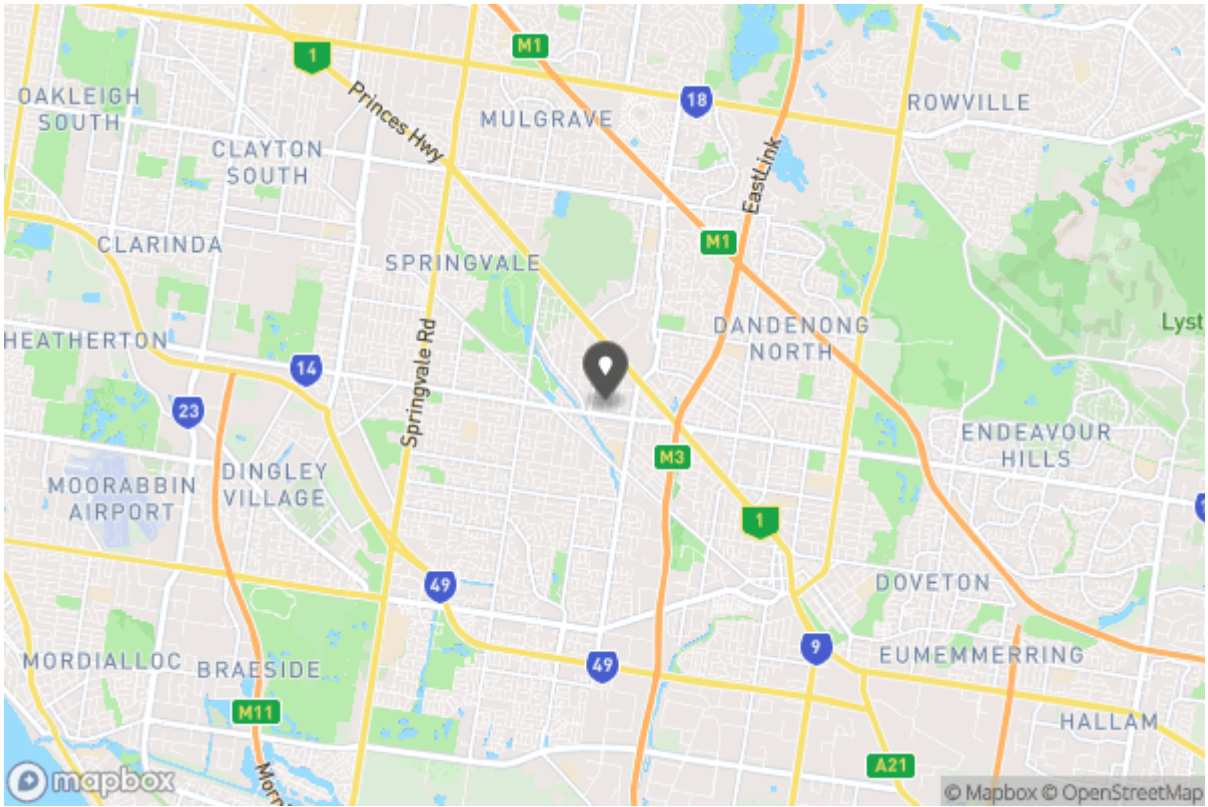

Floor Plans

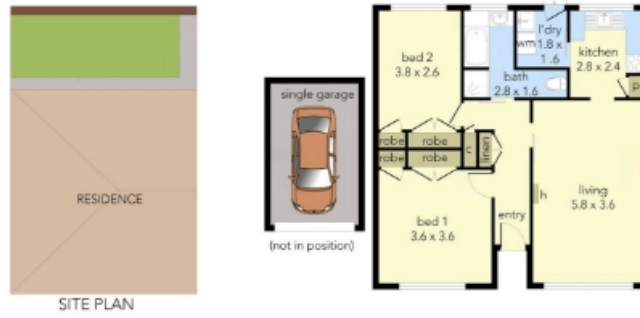

6/14 Ellendale Road, Noble Park

Residence - 74 m²

This floorplan is for illustration purposes only and no warranty is given to its accuracy. Purchasers are advised to carry out their own investigations.



Don't forget to confirm your inspection by SMS or email

Elite Property Management Leasing Department

rentals@theelitegroup.com.au

(03) 5925 9150
5/8 Edward Street
Somerville VIC 3912



Why Book with Elite Property Management Group

With our agency, you can book Property Inspections 24/7 on your computer, tablet or smartphone. When you do, you will receive an immediate response confirming your booking via email and SMS. Should the property be leased, the inspection time changed or cancelled for any reason, you will be informed the second it happens keeping you up to date.

You can also change or cancel your booking at any time if you no longer wish to attend or the times are no longer suitable. As part of your booking, we will send you reminders of the inspection as well as directions to the property to make the process of inspecting the property seamless.

Finally, should you wish to apply for the property, all of the relevant information including PDF or online applications details will be provided so you can apply as quickly as possible.

Tenancy Application

A copy of the General Tenancy Agreement for this property, including all special conditions is available via the following link:

[Apply Online](#)

<https://2apply.com.au/Property?agentAccountName=ElitePMG&address=6%252f14%2bEllendale%2bRoad%252c%2bNoble%2bPark>