



## 513/21 Provan Street CAMPBELL ACT 2612

 2  2  2

\$750

Date available: 6 May 2024

[Book Inspection](#)

### Luxury two bedroom apartment

To view any of our properties, please click on "book inspection" below and fill in your details to register to view the property. Alternatively, you can copy/paste: <https://www.tenantapp.com.au/Rentals/Agency/archer>. It is extremely important, that you register your contact details or risk not being contacted in the event of a cancellation or change in open times.

Danish inspired design oozing class and simplicity; Koben is the latest addition to the Campbell 5 development and boasts uninterrupted views of Lake Burley Griffin and Parliamentary triangle.

Conveniently located on the City Centres fringe and neighbours with the Russell offices, the sleek and stylish finishes are nothing but impressive.

Features include:

Two bedrooms - Master with ensuite

Built in robes to both bedrooms

Reverse cycle heating and cooling

Double glazed doors/windows

Stainless steel appliances including microwave and induction cooktop

Visual intercom

Archer Canberra

Floating timber floors  
Full length balcony  
European laundry with dryer  
Additional storage space with coat rack  
Two car spaces  
Allocated storage cage  
NBN availability  
Heated Floors and towel rack in both bathrooms

This luxury apartment will take your breath away upon opening the door so be quick to avoid missing out.

**Bond and Rent:**

A bond equal to four weeks' rent will be required before the commencement of the lease. Here at Archer Canberra, we accept rent weekly, fortnightly, or monthly and our preferred payment method is direct debit.

**When can I see the property?**

Saturday exhibition times will be advertised by close of business each Wednesday. Should the open time not suit, please call our dedicated leasing department to arrange a personal inspection. Please note if the property isn't advertised as "Available Now" this means that the property is currently tenanted, making Saturday viewings all that we will have available until after this date.

**Interested in applying for this property?**

Once you register or view the property, you'll receive a link from our leasing system:  
<https://www.2apply.com.au/Agency/Archer>.

**Disclaimer:**

Whilst care has been taken in gathering details for properties for lease, we accept no responsibility for any inaccuracies herein. All applicants should rely on their own research to confirm any information provided.

**Useful Information:**

- A 12 month lease is the standard lease term anything longer or shorter will be advertised or considered upon application.
- It is policy to either view the property, or have someone view the property on your behalf before your application can be accepted.
- This property meets the minimum energy standard.
- Pets will be considered upon application only.



# Gallery





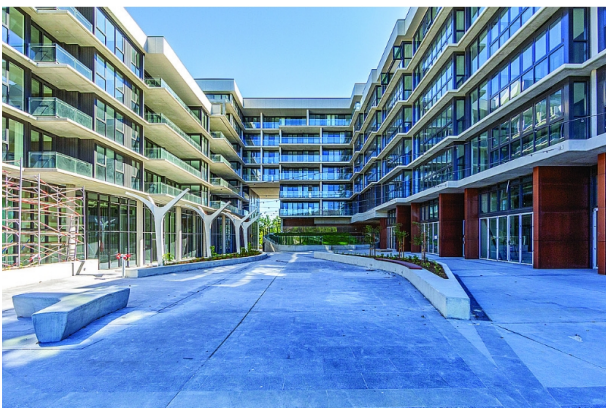

# Location Map







Don't forget to  
confirm your  
inspection by  
SMS or email

## Leasing Archer

[leasing@archercbr.com.au](mailto:leasing@archercbr.com.au)

02 6262 5232  
1/24 Girrahween Street  
Braddon ACT 2612



## Why Book with Archer Canberra

With our agency, you can book Property Inspections 24/7 on your computer, tablet or smartphone. When you do, you will receive an immediate response confirming your booking via email and SMS. Should the property be leased, the inspection time changed or cancelled for any reason, you will be informed the second it happens keeping you up to date.

You can also change or cancel your booking at any time if you no longer wish to attend or the times are no longer suitable. As part of your booking, we will send you reminders of the inspection as well as directions to the property to make the process of inspecting the property seamless.

Finally, should you wish to apply for the property, all of the relevant information including PDF or online applications details will be provided so you can apply as quickly as possible.

# Tenancy Application

A copy of the General Tenancy Agreement for this property, including all special conditions is available via the following link:

[Apply Online](#)

<https://2apply.com.au/Property?agentID=PM-Archer&uniqueID=b14f004527b34b67ade474aa45a591e1>