



— LEASED —



3 Alfred Deakin Grove Skye VIC 3977

 3  2  2

\$570 per week | LEASED

Date available: Now

[Book Inspection](#)

- SET TO IMPRESS -

New to the rental market & sure to impress the astute renter, this family home offers an immaculate interior, neutral tones and a dedicated home office.

Situated closely to all amenities, this family abode offers:

- Three spacious bedrooms all with built in robes
- Master bedroom with walk in robe & ensuite
- Three living zones
- Spacious kitchen with dishwasher
- Central bathroom with access through to bedroom three
- Split system cooling
- Ducted heating
- Double garage

The enclosed rear yard is fenced and low maintenance, offering a great space for the family to enjoy. A tranquil vibe offers a grassed hut entertaining zone, bamboo lined fencing & synthetic grass to the back yard plus monthly lawn care will be provided within the terms of the lease agreement.

3 Alfred Deakin Grove Skye VIC 3977

TO INSPECT THIS PROPERTY

To attend this inspection, you must pre-register. By clicking the "Book Inspection" button you will be notified of all available inspection dates and times plus any changes that may occur.

TO APPLY FOR THIS PROPERTY

To submit your application on this property please use 2Apply. Visit our website at www.elitepmg.com.au select the property address and select Apply Online.

DISCLAIMER

Elite Property Management Group has relied in good faith in the preparation of information provided. Elite Property Management Group has made all reasonable efforts to ensure all information provided to you is true & correct. The accuracy of the information provided to you cannot be guaranteed. If you are considering this rental home, you must make all enquiries necessary to satisfy yourself that all information is accurate.

Gallery









Location Map

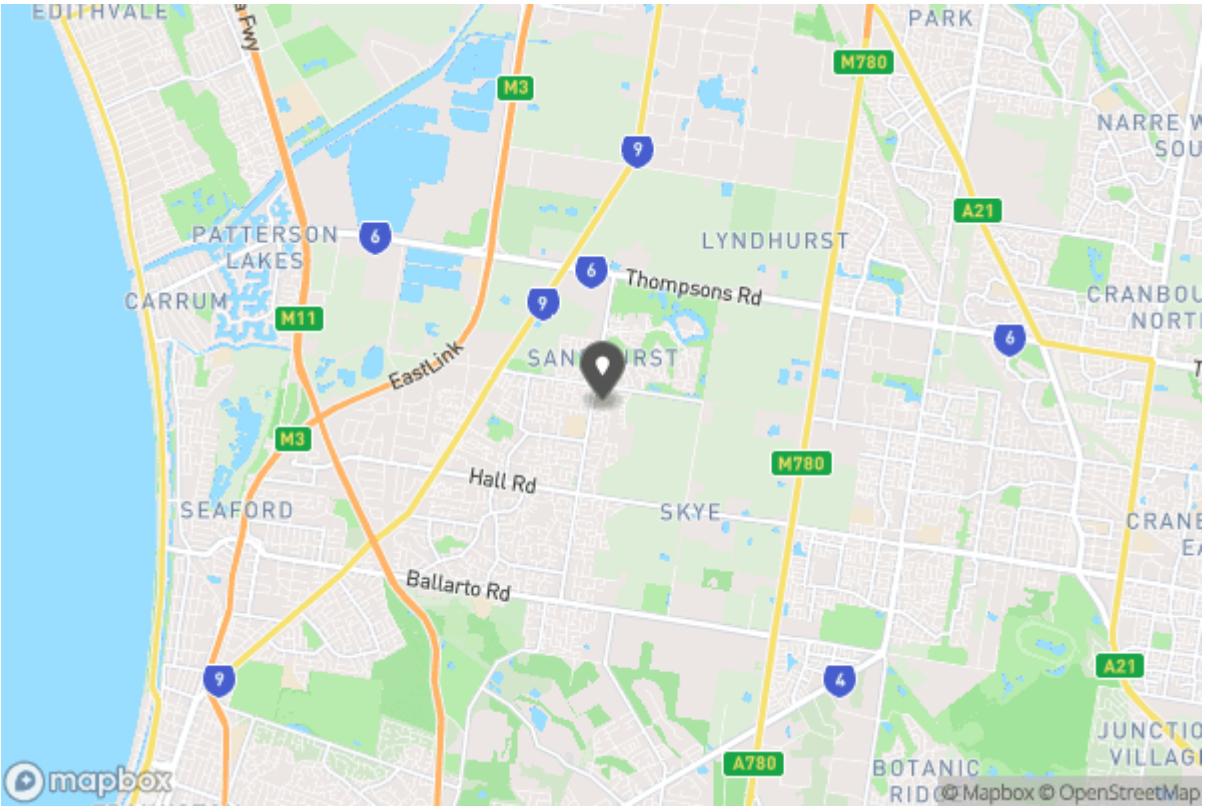

Floor Plans

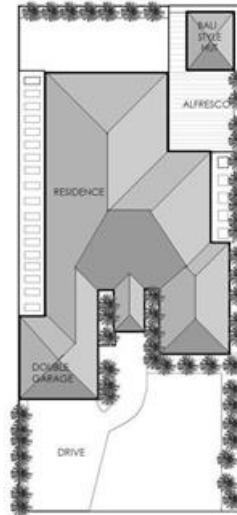

- Internal living area approx: 20 squares
- Garage area approx: 4 squares
- Alfresco, and porch approx: 6 squares
- Total area approx: 30 squares
- Land area approx: 531 sqm
- Original build 2003

3 Alfred Deakin Grove, Skye

©Produced by DND Floorplans

This floorplan is a guide only and no warranty is given to its accuracy in dimensions. Purchasers are advised to carry out their own investigations.



Don't forget to confirm your inspection by SMS or email

Elite Property Management Leasing Department

rentals@theelitegroup.com.au

(03) 5925 9150
5/8 Edward Street
Somerville VIC 3912



Why Book with Elite Property Management Group

With our agency, you can book Property Inspections 24/7 on your computer, tablet or smartphone. When you do, you will receive an immediate response confirming your booking via email and SMS. Should the property be leased, the inspection time changed or cancelled for any reason, you will be informed the second it happens keeping you up to date.

You can also change or cancel your booking at any time if you no longer wish to attend or the times are no longer suitable. As part of your booking, we will send you reminders of the inspection as well as directions to the property to make the process of inspecting the property seamless.

Finally, should you wish to apply for the property, all of the relevant information including PDF or online applications details will be provided so you can apply as quickly as possible.

Tenancy Application

A copy of the General Tenancy Agreement for this property, including all special conditions is available via the following link:

[Apply Online](#)

<https://2apply.com.au/Property?agentID=ElitePMG&uniqueID=IRE3582047>